



TIER LITE WALL MOUNT

Tier Lite provides 360 degree illumination on a horizontal plane without projecting vertical light. It is ideal for lighting areas like porches and entranceways.

Pole mount version also available.

DETAILS.

FINISHES AVAILABLE IN:

ALUMINUM POWDERCOAT- BLACK, BRONZE, OLIVE GREEN, WHITE, WHITE BIRCH, DARK GREY, SILVER STAR, CORTEN

SOLID COPPER

316 STAINLESS STEEL

SIZE: 6 1/8" H X Ø10 1/4" SHADE

STANDARD BACKPLATE: Ø3 1/16" X 1 1/8" W

RETRO BACKPLATE: Ø3 1/16" X 2 3/16" W

MAX 1050MA, CRI 90

COLOR TEMPS AVAILABLE:

2700K, 3000K, 4000K

BEAM ANGLE: 360°

POWER OPTIONS:

S - SERIES, REMOTE DRIVER

D3 - 12V AC, 2W INTEGRAL DRIVER

D7 - 12V AC, 4W INTEGRAL DRIVER

D10 - 12V AC, 6W INTEGRAL DRIVER

R - RETRO, 110/240V DRIVER

*REMOTE DRIVER WIRED IN SERIES. INTERNAL DRIVER WIRED IN PARALLEL.

IP66 - RATED FOR WET LOCATIONS.

*OTHER ACCESSORIES AND LAMP OPTIONS AVAILABLE.

UL LISTED

Tier Lite Wall Mount

PURELED SPECIFICATIONS

LED Chip	Cree XHP-50-2 Plug and Play field replaceable LED board
Luminaire Output	510 Lumens @ 1050mA (6 watts), 340 Lumens @ 700mA (4 watts), 160 Lumens @ 350mA (2 watts), delivered from luminaire with unobstructed beam.
Lumens Per Watt	85 lumens minimum @ 6 watts, delivered from luminaire with unobstructed beam
CRI (3000K)	90+
Colour Temperatures	2700K, 3000K, 4000K
Beam Angles	360 degrees
Ingress Protection	IP66
Warranty	Electronics = 5 years Body Cop/ SS = 10 years Body Aluminium = 5 years
Standards	AS/NZS 61046, EN60598 cUL 1838, 2108, 1598 CSA C22.2 No. 250.7, No. 250.0-08, No. 250.0 CE

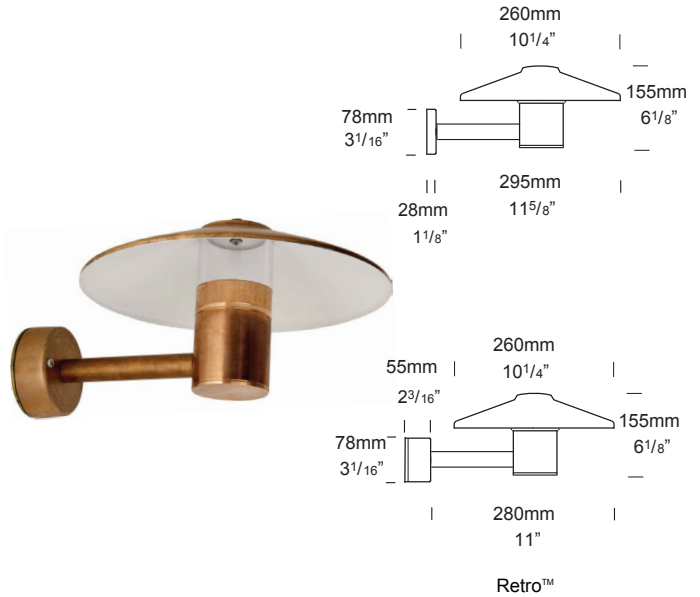

PRODUCT CONFIGURATION

Please fill in appropriate codes into boxes provided

Cat. No. TLWM/L

Luminaire	Power	Material/ Finish	Beam	Colour	Accessories
TLWM/L					
S SERIES, REMOTE DRIVER D3 12VAC, 2W INTEGRAL D7 12VAC, 4W INTEGRAL D10 12VAC, 6W INTEGRAL R RETRO, 110/240V DRIVER		ALUMINIUM EBK BLACK EBZ BRONZE EOGR OLIVE GREEN EWH WHITE EWB WHITE BIRCH EDG DARK GREY ESTAR SILVER STAR ECT CORTEN COP SOLID COPPER SS STAINLESS STEEL	360 360°	2 2700K 3 3000K 4 4000K	WBAP WALL BOX ADAPTOR CJK CABLE JOINT KIT BOLOP OPAQUE LENS

SERIES, REMOTE DRIVER REQUIRED:
Constant current driver
Individual fixtures require 6vdc @ 1050mA maximum

12VAC INTEGRAL DRIVER:
Hunza integrated plug and play driver (included)
Input: 9-15VAC
Output: 6vdc @ D3=350mA, D7=700mA, D10=1050mA (1050mA limited to ≤ 40°C (104°F) ambient temperature in stainless steel)

110/240VAC RETRO DRIVER:
Input: 120/240vac, 5 watt total (driver included)
Output: 6vdc, 700mA (non dimming)

OTHER LAMP OPTIONS:
 TLWM/H - MR16 Halogen 12V Lamp
 TLWM/SL - MR16 LED Retrofit 12V Lamp (lamps vary by market - please refer to supplier for details)
 TLWM/GUH - GU10 120/240V Halogen Lamp (body length increases for all GU10 lamps)
 TLWM/GUSL - GU10 LED Retrofit 120/240V Lamp (lamps vary by market - please refer to supplier for details)

[Click here for halogen specification sheet](#)

[Click here for 240v Remote Power Supply Guidance Charts](#)

[Click here for USA Remote Power Supply Guidance Charts](#)

LUMINAIRE CONSTRUCTION

CNC machined from one of the following metals:

Aluminium:

Body: high corrosion resistant 63.5mm (2^{1/2}") x 10mm (3/8") aluminium.
 End cap: 63.5mm (2^{1/2}") aluminium rod.
 Pole: 25.4mm (1") x 1.42mm (1/16") aluminium rod.

Base and Mounting Plate (Retro™): handspun 2mm (5/64") aluminium. Base cast from virgin CC401 low copper aluminium alloy chromate substrate and high UV resistant polyester powder coat.

Colours:

Black, Bronze, Silver Star, White, White Birch, Olive Green, Dark Grey, Corten.

Copper:

Body: 63.5mm (2^{1/2}") x 10mm (3/8").
 End cap: 63.5mm (2^{1/2}") copper rod.
 Pole: 25.4mm (1") x 1.42mm (1/16") copper rod.

Base and Mounting Plate (Retro™): handspun 2mm (5/64") copper disk and forged brass.

316 Stainless Steel:

Body: 63.5mm (2^{1/2}") x 10mm (3/8").
 End cap: solid 316 stainless steel 63.5 (2^{1/2}") rod.
 Pole: 316 stainless steel 25.4mm (1") x 1.42mm (1/16") rod.

Base and Mounting Plate (Retro™): investing cast and CNC machined 316 stainless steel.

Lens:

UV stable clear polycarbonate with stainless anti-glare mesh.

Hood:

260mm (10^{1/4}") x 1.2mm (0.5") hand spun aluminium, copper or stainless steel.
NOTE: The underside of copper and aluminium hoods have a white coating to maximise light reflection.

Gaskets:

Silicone, iron impregnated 220°C (428°F)

Mounting:

12 volt: the luminaire is mounted to the wall using two 316 stainless screws through a shallow base 28mm (1^{1/8}") in depth.

Retro™ (110/240-12volt): a mounting plate is fixed to the wall using two screws and the luminaire is fitted to the mounting plate.

Luminaire Weight:

Low voltage
 Alum: 0.915kg (2lb)
 Cop: 1.590kg (5lb 11oz)
 SS: 1.450kg (3lb 3oz)
 Retro™
 Alum: 2.000kg (4lb 6oz)
 Cop: 3.000kg (6lb 9oz)
 SS: 2.900kg (6lb 6oz)

ACCESSORIES

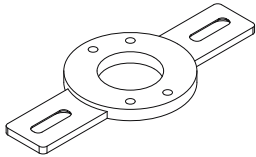

Wall Box Adaptor

BEAM ANGLES

IES files available for download: hunzalighting.com/downloads

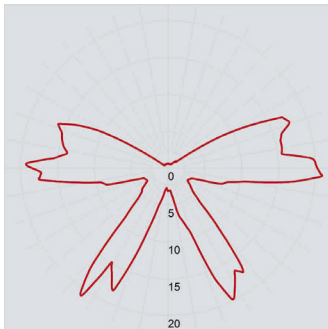

Polycarbonate lens

WIRING GUIDE

Series/remote driver

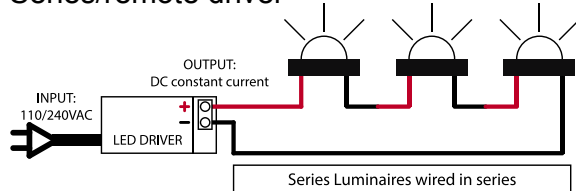

Diagrams are a guide only, wire colours and polarity may change depending on fixture and country

Available for download: hunzalighting.com/downloads

12v integral driver

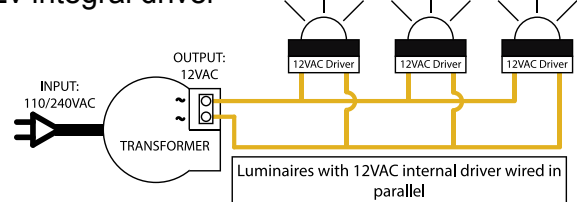

FINISHES

Powdercoated Aluminium



Solid Metals

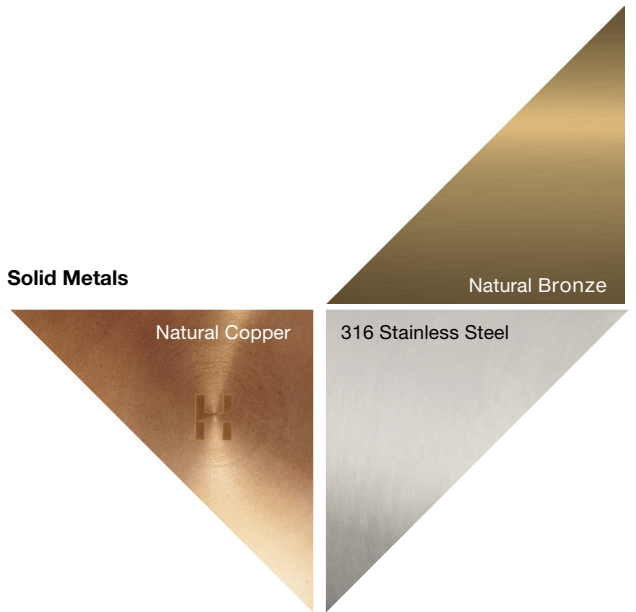

- Due to the limitation of print and screen resolution these colours should be used as a general guide only
- Solid copper and bronze are natural finishes designed to gradually weather & patina
- Solid stainless steel may acquire a surface tarnish in certain environments. Regular washing is recommended to avoid this.