

HL-834-LED

Solid brass LED in-grade adjustable light. Fixture supplied with 3ft of SJO low voltage wire. Mounting/pour flange recommended (HL-8PH). Suitable for wet location installations. Halogen version also available.



DETAILS.

MATERIALS AVAILABLE IN: CAST BRASS

FINISHES AVAILABLE IN:

BK – BLACK POWDER COAT

BZ – BRONZE POWDER COAT

WT – WHITE POWDER COAT

AP – ALUMINUM POWDER COAT

N – NATURAL BRASS

SIZE: Ø5 3/8" X 4" H; Ø3 13/16" BODY

LED OPTIONS, 85 CRI:

3W = 180 LM

8W = 300 LM

8E (8.4W) = 565 LM

COLOR TEMPS AVAILABLE:

2700K -OR- 3000K

OPTIC OPTIONS:

3W/8W – 12° SPOT, 24° NARROW FLOOD, 36° FLOOD

8E – 14° SPOT, 25° NARROW FLOOD, 30° MEDIUM FLOOD, 40° FLOOD

DIMMING: ELV/MLV

12VAC TRANSFORMER REQUIRED – NOT INCLUDED.

RATED IP67 FOR WET/DAMP/DRY LOCATIONS.

***OTHER ACCESSORIES AVAILABLE.**

ETL LISTED

HL-834-LED



II P L

PLUGLIGHTING.COM
INFO@PLUGLIGHTING.COM

5665 MELROSE AVENUE
STE 108 LOS ANGELES 90038

P. 323 467 5635
F. 323 467 5634

SPECIFICATIONS

DESCRIPTION:

Compact recessed in grade fixture with adjustable light source. Suitable for wet/damp location installations.

MATERIAL:

Standard overall material is brass
HL-834 - Cast Brass

FINISH:

AP - Powder Coat Aluminum
BK - Powder Coat Black
BZ - Powder Coat Bronze
WT - Powder Coat White
N - Natural Brass

HALOGEN LAMPING OPTION:

Lamp Type - 12V halogen MR16 lamp, bi-pin GX5.3 base, 50W max, not included (standard).

LED OPTIONS

Integral high output LED, warm white 85 CRI (3000K CCT) standard, others available.

3LED - 3W LED - 180 lumens
8LED - 8W LED - 300 lumens
8LED-E - 8.4W LED - 565 lumens

OPTICS

3LED and 8LED:

SP - Spot, 12°
NF - Narrow Flood, 24°
FL - Flood, 36°

8LED-E:

SP - Spot 14°
NF - Narrow Flood, 25°
MF - Medium Flood, 30°
FL - Flood, 40°

VOLTAGE:

12 - 12 VAC output transformer required, not included. 2ft SJO cord included.

MOUNTING:

Suitable for installation into concrete, masonry or any other non-combustible material.

OPTIONS:

Pour Housing

HL-8PH - Brass flange, PVC tube
 See fixture accessories for more information.

SAMPLE ORDER SPECIFICATION:

HL-834-N-12-HL8PH

RATING:

Wet/damp location - IP67

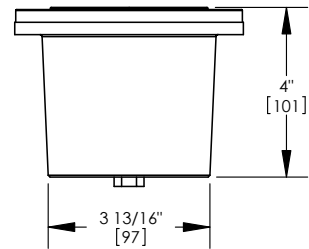
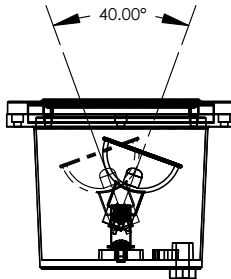
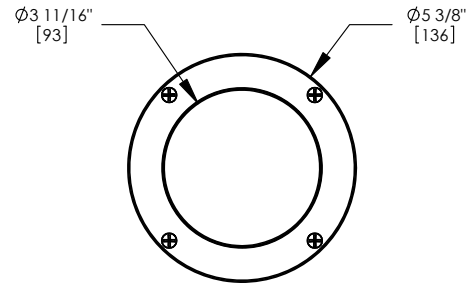

CATALOG NUMBER:

HL-834

Standard Finishes



AA - Anodized Satin Aluminum



AP - Aluminum Powder Coat

Natural Finishes



N - Natural Brass

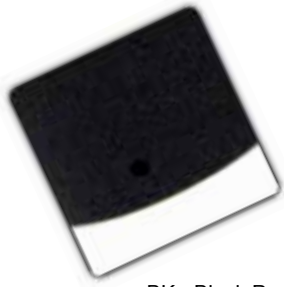

BK - Black Powder Coat

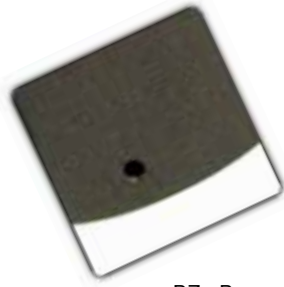

BZ - Bronze Powder Coat



N - Natural Stainless Steel



WT - White Powder Coat

Custom Finishes



Custom Finishes

